



*Point of Professional View*

*perfect experience,  
stable performance*

stability | performance | durable | robust



**Filling Technologies**

*perfect experience,  
stable performance*

*Point of Professional View*



KULP® is established by Cuneyt Dogrusoz in Istanbul on 1984 to remedy the need of packaging machinery. The first production has started as engineering and manufacturing of filling machines, mixer tanks and cosmetics machinery. Later on the company added its' production line some new projects as cap sorting systems, capping machines, labeling machines and transfer pumps for liquids & pastes for the food, cosmetics, chemical, paint, bakery and dairy industries.

KULP® employs up to 50 experts within a 1000 m2 production area on production, sales, after-sales & management departments.

Today KULP® continues to increase its' export sales to the world's seven continents via sales partners located in Germany, Belgium, Greece, Australia, Italy, Ukraine , United Kingdom , United States and Colombia.

KULP® keeps its' leading position by designing and producing high-quality, long-life packaging equipments including professional after-sale services with more than 1500 references in Turkey and abroad day by day.

## FILLING



### Volumetric Filling Machines

Starting from semi automatic solutions to high capacity In-Line filling machines presenting the functionality and stability

## CAPPING



### Cap Sorting & Capping Solutions

Capping systems for different types of caps including the simplicity of adjustments for different types of caps

## LABELLING



### Labellers for Pressure Sensitive Labels

High labelling accuracy integrated with the flexibility of labellers for wide range of packages

VD Series Semi Automatic Filling Machines	02-03
D Series Semi Automatic Filling Machines	04-05
Automatic Filling Machines	06-07
Cap Sorting Systems & Capping Machines	08-09
Labellers for Pressure Sensitive Labels	10-11
Accessories;	12-13
• Feeding Tables • Collecting Tables • Volumetric Transfer Pumps • Double Jacketed Hoppers • Agitators	
• KULP OEM Filling Systems For Vertical & Horizontal Packaging Machines	

# Semi Automatic Filling Machines

## Filling Pastes & Creams



### Height Adjustable Frame

Designed for easy installation on conveyor lines and packaging machines.

- Height adjustment with hand wheels and numerators
- Easy to move for cleaning processes.

VD-50-1-01



VD-150-1-02



<b>Filling Range (ml)</b>	5 - 50	15 - 150
<b>Filling Range with optional cylinder (ml)</b>	2 - 20	5 - 50
<b>Capacity (packages/hour)</b>	2000	1800
<b>Hopper Volume (l.)</b>	30	30
<b>Air Consumption (l./min)</b>	75	75
<b>Dimensions (W/L/H) (mm)</b>	606/1050/1440	606/1140/1440
<b>Weight (kg)</b>	50	60

### KULP VD Series is VERSATILE

Because;

- Fills semi-liquid, creamy and paste products with particles into packages.
- Used in food, bakery, cosmetics, chemical, pharmaceutical, paint and dairy industries.
- Volumetric piston system.
- Works with pneumatic control. Only 6 bars of compressed air is enough to work out.
- Filling range from 5 ml. to 5000 ml.
- Filling accuracy  $\pm 1\%$ .
- Primes the product directly from the hopper or the production tank which is located above the machine.
- The rate of prime and eject is variable and adjustable individually by choke valves.
- Manual and continuous operation from control box.
- Table-top or castored versions.
- Wide range of nozzle accessories.

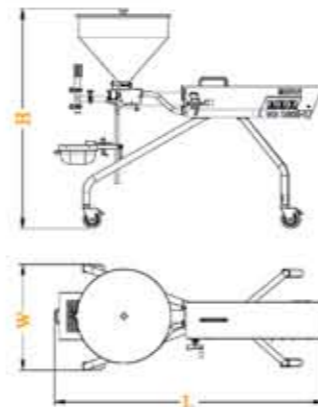

### Filling Nozzles



SN 08 Injection nozzle for bakery applications.

SN 024 Filling yeast for dairy products.

SN 025 Filling milk for 1 liter packages.

SN 027 Filling milk for 5 liter packages.

SN 05 Paint Filling Nozzle

SN 01 Filling liquid & viscous products.

SN 02 Filling liquid & viscous products.

VSN 03 Filling viscous products with particles inside.

SN 035 Filling viscous products with particles inside.

VD-500-1-02



VD-1000-1-02



VD-2000-1-02



VD-5000-1-02



<b>Filling Range (ml)</b>	50 - 500	100 - 1000	200 - 2000	500 - 5000
<b>Filling Range with optional cylinder (ml)</b>	20 - 200	20 - 400	50 - 1000	145 - 1450
<b>Capacity (packages/hour)</b>	1000	720	600	420
<b>Hopper Volume (l.)</b>	80	80	80	80
<b>Air Consumption (l./min)</b>	250	250	250	300
<b>Dimensions (W/L/H) (mm)</b>	680/1160/1407	740/1875/1527	740/1875/1527	720/2180/1527
<b>Weight (kg)</b>	120	140	140	160

### VD Series Can Be Used In;

#### Food Industry:

Honey, marmalade, jam, fruit pastes&fillings, purees, salsa, molasses, peanut butter, cottage& ricotta cheese, jelly, creams,salads, dressing sauces with particulates, preserves, ketchup, mustard, mayonnaise, mashed potato, soups, confectionery spreads, juice concentrates etc.

#### Bakery Industry:

Rice pudding, whipped cream, muffin cake, ice cream, berries in cake dough, milk pudding, coconut, sponge dough, yellow cream, brioche, cake batter, chunky batter, mousse, chocolate pudding, strews, pureed spinach, cheese paste, meat pie filling, gravy&chunky salsa, also injecting icing, marmalade or chocolate sauces into the muffins, donuts, croissants....

#### Cosmetics Industry:

Viscous shampoos, creamy hair lotions, body&face care products, peeling creams, gels&creams, soaps, face&body masks, SPA creams, nail care products, mascara, eyeliner, lipgloss, foam&cream foundation, nail varnish, waxes, body butter etc.

#### Chemical Industry:

Paints, (water, synthetic based), finger paints, varnishes, creams&gel detergents, glue, paste cleaners, petroleum jelly, viscous mineral oils, cream&paste cleaners, cream shoe paints, automotive, household and industrial products etc.

#### Pharmaceutical Industry:

Ointments, lotions, viscous syrups, glycerin, veterinary, bio-medical and sanitary products etc.

# Semi Automatic Filling Machines

## Filling Liquids

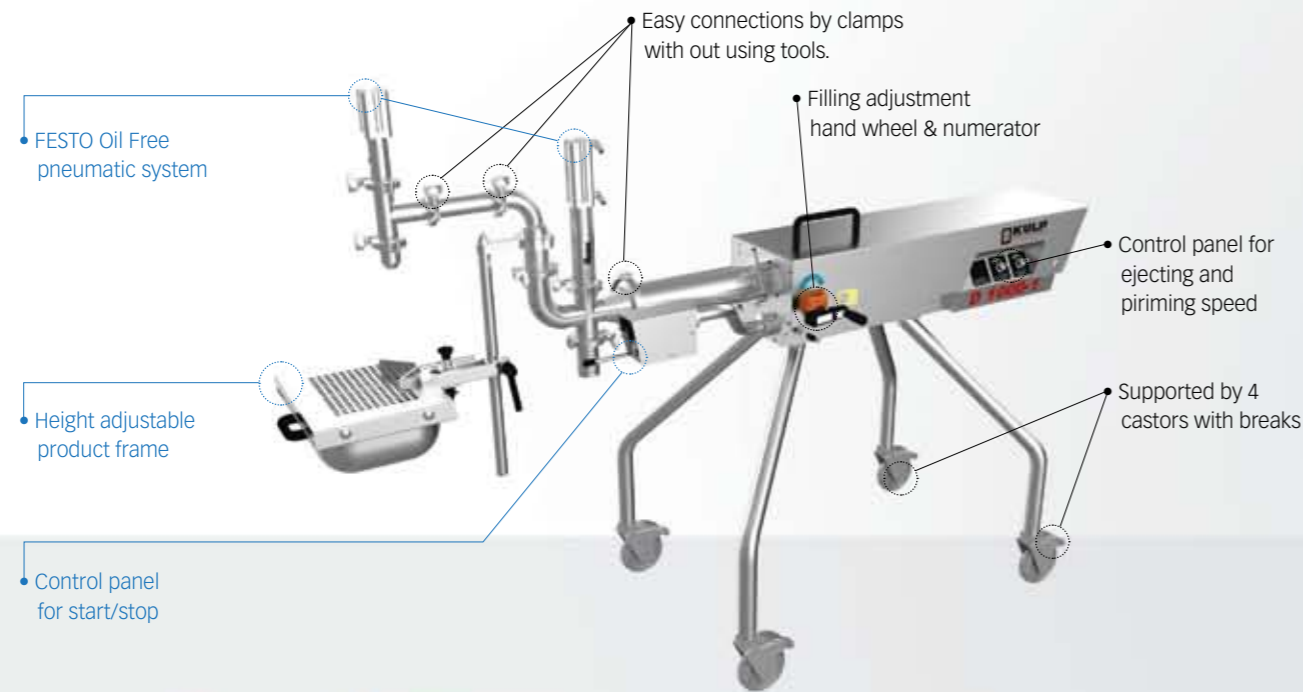

Experience the simplicity & functionality



D-50-1-01



D-150-1-02



<b>Filling Range (ml)</b>	5 - 50	15 - 150
<b>Filling Range with optional cylinder (ml)</b>	2 - 20	5 - 50
<b>Capacity (packages/hour)</b>	2000	1800
<b>Air Consumption (l./min)</b>	75	75
<b>Dimensions ( W/L/H ) (mm)</b>	606/1090/1295	606/1145/1295
<b>Weight (kg )</b>	40	50

### KULP Fillers Are Hygiene

Because;

- Getting touch with the product are made of stainless steel 316L.
- Sealings are Teflon, Viton, Polyethylene according to the product to be filled.
- All parts are connected by tri-clovers.
- Can be assembled toolless and easily cleaned.
- Highest surface roughness against contamination.

### Easy & Safe To Use

Because;

- No danger of fire, it is exproof.
- All moving parts are guarded.
- CE marked.
- Easy to adjust the filling range from the numerator and hand wheels.
- Easy changeover with tri-clovers.
- Has quick-release fittings.

D-500-1-02



D-1000-1-02



D-2000-1-02



D-5000-1-02



<b>Filling Range (ml)</b>	50 - 500	100 - 1000	200 - 2000	500 - 5000
<b>Filling Range with optional cylinder (ml)</b>	20 - 200	20 - 400	50 - 1000	145 - 1450
<b>Capacity (packages/hour)</b>	1000	720	600	420
<b>Air Consumption (l./min)</b>	250	250	250	300
<b>Dimensions ( W/L/H ) (mm)</b>	680/1795/1415	680/2060/1415	680/2060/1415	720/2350/1415
<b>Weight (kg )</b>	110	130	130	150

### D Series Can be Used In

**Food Industry:**

- Honey, marmalade, fruit juices, dressing sauces, ketchup, fruit concentrates, olive oil, sun flower oil, syrups.

**Cosmetic Industry:**

- Shampoos, body and face lotions, liquid moisturizers, gels, herbal and massage oils, sun care products, perfumes, cologne, acetone.

**Chemical Industry:**

- Engine oils, antifreeze, polishes, liquid detergents, liquid soaps, solvents, paints (water, synthetic based).

**Pharmaceutical Industry:**

- Lotions, glycerin, liquid veterinary products.

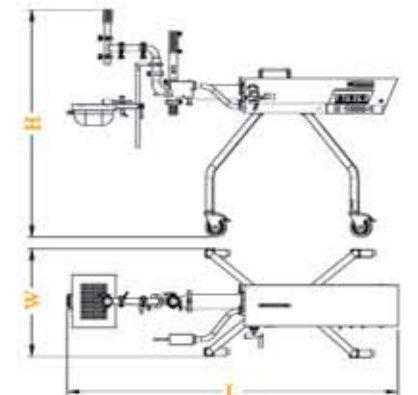

LABELLING

CAPPING

FILLING

D SERIES

# Automatic Filling Machines

## KULP Easy Line

### Filling Station;

- VD or D series filler ?
- Filling Range?
- One head or two head Filler ?
- Need a Double Jacketed hopper ?
- Need a agitator ?
- Height Adjustment Frame or Diving Nozzle ?

### Capping Station;

- Screw Cap , Twist- Off Cap, Push On (Snap On) Cap ?

### Labelling System;

- Type of labeling (All around, front – back side or topside) ?
- Type of packages?
- Dimensions of Labels ?

### Collecting Table;

- Diameter 980 mm or 1200 mm ?
- Stable 3 turns/minute or Optional Speed Adjustment ?

### Feeding Table;

- Diameter 980 mm or 1200 mm ?
- Stable 3 turns/minute or Optional Speed Adjustment?

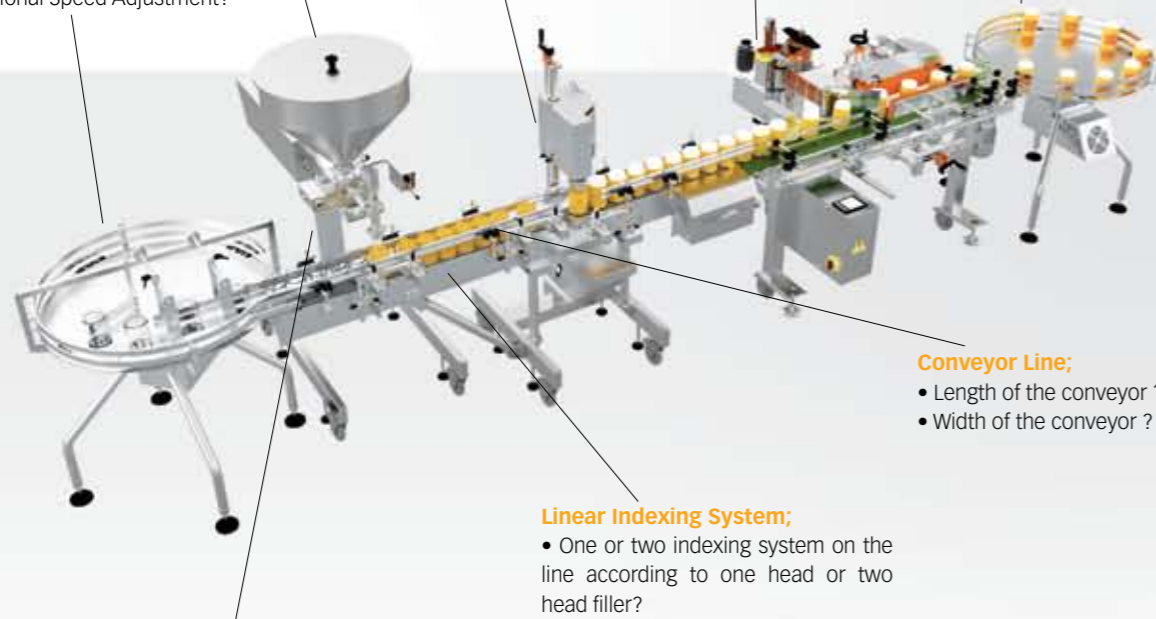

### Conveyor Line;

- Length of the conveyor ?
- Width of the conveyor ?

### Linear Indexing System;

- One or two indexing system on the line according to one head or two head filler?

### Height Adjustment Frame;

- The difference between the lowest and the highest container?

### KULP Easy Line

KULP EASY LINE is a compact and robust automatic packaging system which consists of filling, capping and labelling systems for the companies who need a packaging line with a capacity up to 1200 containers / hour.

With the KULP EASY LINE, the users can design their own packaging line according to their specific needs from the KULP equipments which are placed on this brochure for their production. So they do not have to pay for the extra equipments that they will never use.

You only need to specify the technical specification under each headline. That is all. The rest is our profession to suit your needs with KULP Equipments quality and reliability.

# KULP VD-4 OT

## Automatic In-Line Filling Machine

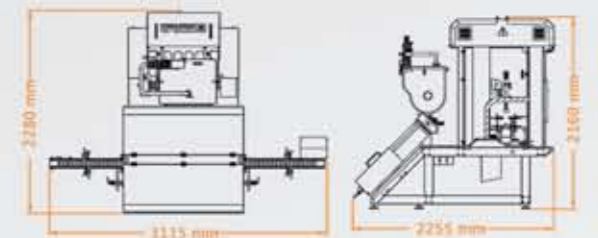
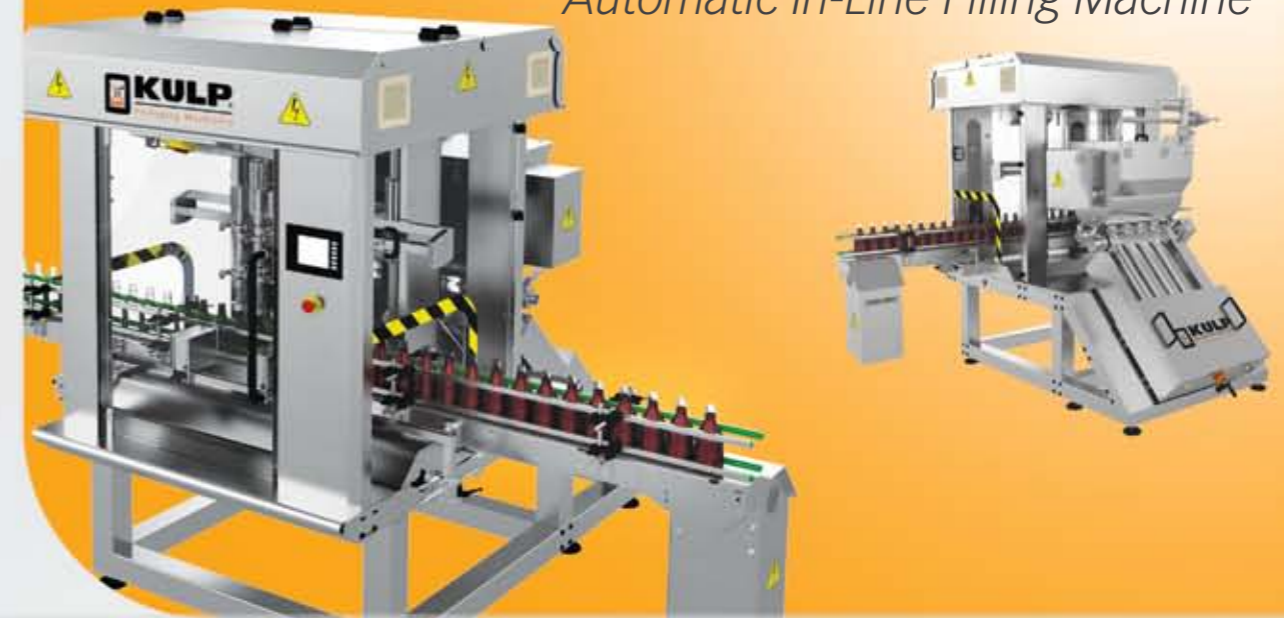

KULP Automatic In-Line Filling Machines are designed to fill liquid, semi liquid, viscous and paste products with particles inside into the glass, plastic and tinplate packages with a filling range starting from 5 ml. up to 5000 ml.

### Technical Specifications

- Works with volumetric piston system.
- Specific design of filling station with 45 angle for higher filling accuracy.
- OIL FREE FESTO pneumatic system.
- OMRON Servo motor and electronic equipments.
- Touch Panel Control System.
- Filling Accuracy is  $\pm 1\%$
- The parts that contact with the product are 316 L stainless steel and other parts are 304 stainless steel.
- Primes the product from 120 liter hopper with an automatic level control system.
- Adjustable priming and filling speeds.
- The filling range is adjustable by a hand wheel and a numerator system.
- All the parts including the main valve and the nozzles are connected by tri-clamps. Very easy to disassemble for cleaning processes.
- Diving Nozzle System controlled by a SERVO drive.
- All the pneumatic and electronic parts are placed on the top of the machinery preventing damages from the cleaning process with water or C.I.P.
- Different type of filling nozzles according to the product, to be filled, with anti dropping system.
- C.I.P. Suitable Cleaning System.
- Optional cleaning system on the backside of the pistons inside the cylinder for sticky products.
- Optional Double Jacketed hopper
- Optional Agitator

Model	Min Filling Range (ml)	Max. Filling Range (ml)	Number Of Filling Cylinders	Capacity (packages / hour)
VD-50-6 OT	5	50	6	6000
VD-150-6 OT	15	150	6	5500
VD-500-4 OT	50	500	4	3500
VD-1000-4 OT	100	1000	4	3240
VD-2000-4 OT	200	2000	4	2850
VD-5000-2 OT	500	5000	2	1680

The filling capacity of the fillers above can increase or decrease according to the viscosity and the specifications of the products that will be filled with in the machine and the use of the diving nozzle or not.

# Capping Systems

# Cap Sorting Systems

LABELLING  
 CAPPING  
 FILLING

CAPPING SYSTEMS



## KULP KAP-901 Semi Automatic Capper

KULP KAP 901 Semi Automatic Capper is a portable hand held capping system which is capable of tightening Plastic Screw Caps and Metal Twist-Off Caps. KULP KAP 901 Semi Automatic Capper is a perfect and low cost solution for the users who needs a capacity of 800 packages / hour.

- Functions with a pneumatic system.
- Takes its motion from an air motor.
- Has a plastic mould to prevent the caps from being damaged because of friction.
- Torque adjustment is done via compressed air inlet.
- Automatically functions if pressed on the cap.
- Automatically stops when reaching the desired torque for the cap.
- The Balancer on the system makes KAP 901 Capper weightless and easy to operate while changing from one package to another.
- Easily installed on working tables or conveyor lines.
- Works for the standard and special sizes of caps.

## KULP KAP-919 Automatic Capping System

KULP KAP 919 Automatic Capping System is a compact solution which is capable of tightening Plastic Screw Caps and Metal Twist-Off Caps. KULP KAP 919 Automatic Capping System easily fits most of the filling lines for jars and bottles with a capacity of 1200 packages/hour.

- Simple and robust design.
- Heavy Duty Stainless Steel Frame.
- Height adjustment is done by the hand wheel and the numerator.
- Easy change over from one package to another.
- Adjustable side rails according to the different size of packages.
- Adjustable indexing system according to the different size of packages.
- Automatically functions when sensing the package on the conveyor line.
- Adjustable conveyor speed.
- Functions with a pneumatic system for tightening the caps.
- Takes its motion from an air motor.
- Has a plastic mould to prevent the caps from being damaged because of friction.
- Torque adjustment is done via compressed air inlet.
- Bottles or jars are fed to the Capping System directly from the filling lines automatically or manually.



## KULP KAP-921 Automatic Capping System

KULP KAP 921 Automatic Capping System is compact solution which is capable of closing Push – On Lids for plastic buckets or metal tin cans. KULP KAP 921 Automatic Capping System easily fits most of the bucket filling lines with a capacity of 1200 buckets/hour.

- Simple and robust design.
- Heavy Duty Stainless Steel Frame.
- Height adjustment is done by the hand wheel and the numerator.
- Eight stainless steel rollers for pressing the lids on the buckets.
- Easy change over from one package to another.
- Adjustable side rails according to the different size of buckets.
- Adjustable indexing system according to the different size of buckets.
- Adjustable conveyor speed.
- Buckets are fed to the Capping System directly from the filling lines automatically or manually.



### Mechanical Sorter

- High flexibility sorter which can handle either long or short height of caps for any diameter.
- Mostly used for high speed applications.
- Replacement of the hopper disc is necessary for different diameter of caps.
- Replacement of the hopper disc is very easy with the use of quick clamps which divides the hopper disc into 4 parts.
- Stainless Steel Frame.
- Needs a elevating system for feeding the caps into sorting system
- Has a safety system which is capable of separating the incorrectly oriented caps.



### Vibrotary Sorter

- Designed for the caps which have diameter smaller than their height or caps with irregular shapes.
- Quick change over parts for different dimensions of caps.
- Variable vibration speed.
- Stainless Steel Frame.
- Needs a elevating system for feeding the caps into sorting system.

### Cap Sorting Elevator

- Designed for the caps which have diameter greater than their height.
- Stainless Steel Frame
- Low profile hopper for caps feeding.
- Elevating and sorting at the same time.
- No need for extra feeding systems to the sorting mechanism.
- No extra change parts for different diameter of caps on sorting system.
- Has a safety system which is capable of separating the incorrectly oriented caps.

Screw Caps \_\_\_\_\_  
 Twist-Off Caps \_\_\_\_\_  
 Push On (Snap on) Caps \_\_\_\_\_  
 Trigger or Dispenser Caps \_\_\_\_\_

## KULP KAP-920 Automatic In-Line Capping System

KULP KAP 920 Automatic In-Line Capping System is especially designed for supporting the high speed linear and rotary filling lines. This system offers a complete and a stable solution for the companies who face problems about cap sorting and capping by the simplicity of its installation and integration on their filling lines.

KULP KAP 920 Automatic In-Line Capping System is a compact solution which is capable of tightening;

Screw Caps • Twist-Off Caps • Push On (Snap on) Caps • Trigger or Dispenser Caps

KULP KAP 920 Automatic In-Line Capping System speeds up to 200 containers / minute.

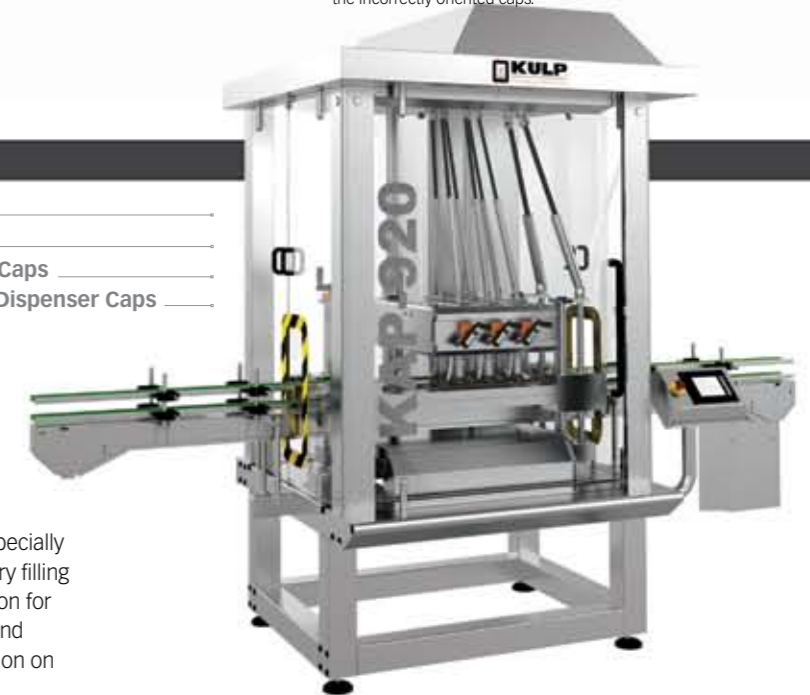

- Heavy Duty Stainless Steel Frame.
- Superior stability of the containers during the cap tightening process by the help of double belt system especially for high containers.
- Motorized height adjustment system for different height of containers.
- User friendly touch screen control panel
- Recording all the adjustments by the help of the numerators and the hand- wheels
- Runs on round, oval, square and rectangle containers without any change parts
- Easy torque adjustments for different type of caps.
- Easy change over parts for different diameter or shape of caps excluding the need for re-adjustment.

# Labellers for Pressure Sensitive Labels

LABELLING  
 CAPPING  
 FILLING

LABELLERS



## KULP E11 Automatic Labellers

- Labels cylindrical, square and hexagonal packages on one side or all-around.
- Easy adjustments by hand wheels and numerators.
- No change parts required for different shapes / sizes of packages.
- Quick change-over from one product another.
- Functional & robust.
- Flexibility for a wide range of packages for now and in the future.
- Can dispense labels min. 8 mm. - max. 128 mm. in width. (Optional dispenser for min. 8 mm. - max. 248 mm.)
- Specific photocells for transparent labels.

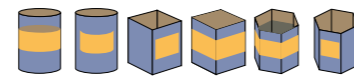

### OPTIONALS

- 1 PRODUCT SEPERATOR DEVICE
- 6 ANGEL ADJUSTMENT DEVICE

### PRODUCT SEPERATOR DEVICE



- Adjusts the required distance between the packages.

### WRAP AROUND DEVICE



- Used for all-round labelling for cylindrical packages.
- Consists of a turning belt & pressure pad.

### CHAIN CENTRALISER



- Product alignment for oval & ellipse packages.
- Quick adjustment for different size of packages.
- No change parts required.



## KULP E30 / E40 Automatic Labellers

- Labels ellipse, oval packages on front & back sides.
- With an optional 'Wrap Around' device, E-30 is upgraded to E-40 that can dispense labels on cylindrical, square and hexagonal packages at one side or all-around.
- Product alignment with 'Chain Centraliser' is performed continuously without any change parts for different sizes of packages.
- Flexibility for a wide range of packages for now and in the future.
- Easy adjustments by hand wheels and numerators.
- Can dispense labels min. 8 mm. - max. 128 mm. in width. (Optional dispenser for min. 8mm. - max.248mm.)
- Specific photocells for transparent labels.
- Encoder systems.

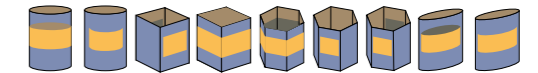

### OPTIONALS

- 1 PRODUCT SEPERATOR DEVICE
- 2 WRAP AROUND DEVICE
- 3 CHAIN CENTRALISER
- 6 ANGEL ADJUSTMENT DEVICE

## KULP E50 Automatic Labellers



- Designed for applying labels on the top & side of the packages.
- The packages are fed to the labeller directly from the filling or capping machine.
- Has an angle adjustment device.
- Labelling accuracy  $\pm 0.5$  mm.
- Can dispense labels min. 8 mm. - max. 128 mm. in width. (Optional dispenser for min. 8 mm. - max. 248 mm.)
- Easy adjustments by hand wheels and numerators.



### OPTIONALS

- 1 PRODUCT SEPERATOR DEVICE
- 6 ANGEL ADJUSTMENT DEVICE

## HOT FOIL PRINTERS



- Prints information on the specific parts on the labels
- Printing area up to 38 mm. x 20 mm.
- Needs 0.041 liter/cycle & 6 bars compressed air.
- 10.000 pieces/hour.
- Foil length up to 244 meters reduces the need for foil reel changes.

### EASY ADJUSTMENTS BY NUMERATORS



- Conveyor width adjustment with only one hand wheel and a numerator.
- Easy change over for different sizes or shapes of products.

### TOP HOLD BELT



- Presses on the products after the chain centraliser in order to protect the product alignment for front & back side labelling.

### ANGEL ADJUSTMENT DEVICE

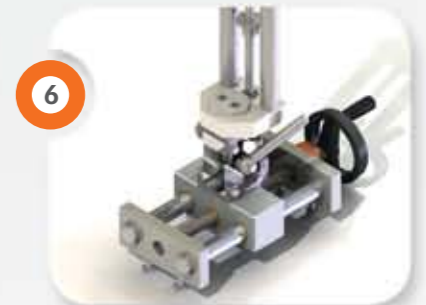

- Performs angel adjustment of labelling head according to the sloped surfaces of packages.

# Accessories



## KULP BT-980 Feeding Table

- KULP BT 980 Feeding table dispatches the round packages in a sequence into the conveyor systems or filling machines.
- Feeding tables are made of 304 stainless steel.
- The diameter of the tables can be either 980 mm or 1200 mm
- Feeding tables have stable 3 turns / minute or has an optional turning speed adjustment.
- The height of the tables can be adjusted to 90 cm ± 5 cm from the four legs separately.

## KULP TT-980 Collecting Table

- KULP TT 980 Collecting table collects any shape of packages from the conveyor systems at the end of the packaging lines.
- Collecting tables are made of 304 stainless steel.
- The diameter of the tables can be either 980 mm or 1200 mm
- Feeding tables have stable 3 turns / minute or has an optional turning speed adjustment.
- The height of the tables can be adjusted to 90 cm ± 5 cm from the four legs separately.

## Transfer Pumps

- KULP Transfer Pumps work with volumetric piston system.
- KULP Transfer Pumps are designed for transferring the products from the cooking vessels, production tanks or storage tanks to the filling systems.
- Pumps are made of stainless steel (the parts contact with the product are 316 L and the other parts are 304 )
- Pumps stand on a stainless steel platform which is supported by 4 castors.
- While the pumps are working with volumetric piston system, they do not process or squeeze the products that they are transferring.
- KULP Transfer pumps capacity is up to 2 tons/ hour according to the type of the product.
- KULP Transfer pumps are divided into three models according the working principles and type of the products that will be transferred.



### KULP P-240



- Designed for transferring liquid and viscous products.
- Works with electricity. ( 380 volts – 1.5 Kw/h)

### KULP PS-40 V



- Designed for transferring viscous products with particles inside.
- Works with compressed air. (6 BARS -300 Liters / Minute )

### KULP AK-905 VERTICAL PUMP



- Designed for transferring the liquid & viscous products especially from the cooking vessels or drums.
- Works with compressed air. (6 BARS -300 Liters / Minute)

# Double Jacketed Hoppers

# Agitators



## Double Jacketed Hoppers

KULP Double jacketed hoppers are designed for keeping the products at a constant temperature during the filling processes.

- Includes a thermostat to heat the water or heating oil between the jackets.
- The required temperature can be adjusted from the control panel which is located on the left side of the hopper easily.
- The heating accuracy for the targeted temperature is ± 1 Celsius.
- Can be easily installed on KULP fillers without need of any modification during the production or after sales.
- There are two different models for the 30 liter and 80 liter hoppers.

## Agitators

KULP Agitators are mostly used for keeping the products, which have particles inside, homogenous on the hopper or spreading the temperature homogenously to the products on the hopper in case of using the double jacketed hopper during the filling process.

- The blades of the agitator can be adjusted at any angle by the users easily.
- Can be easily installed on KULP fillers without need of any modification during the production or after sales.
- The agitator has an adjustable speed with the use of optional speed control device.
- There are two different models for the 30 liter and 80 liter hoppers.

## KULP OEM Filling Systems For Vertical & Horizontal Packaging Machines

KULP OEM fillers are especially designed for vertical or horizontal packaging machines in order to use professional filling systems on these systems. There are different models starting from one to six head machines for various filling ranges.

- Very easy to move for cleaning processes while it stands on a stainless steel platform which is supported by 4 castors.
- Height adjustment frame for easy installation on any packaging machinery.
- Adjustable nozzle scheme for different types of packages
- Can be controlled from the main machine PLC via electro pneumatic valve.
- Optional level indicator system on the hopper to control the feeding systems ( pumps) which transfers the product to be filled.
- Can be easily installed by the professionals during the production of the packaging machines or end users after the sales of the packaging machinery.







Çavuşbaşı Caddesi No:56-A 34782  
Çekmeköy, İSTANBUL - TURKEY

Phone :+90(216) 641 21 83 (pbx)

Fax :+90(216) 641 21 85

e-mail : info@kulp.com.tr

*perfect experience,  
stable performance*



[kulp.com.tr](http://kulp.com.tr)



[www.kosgeb.gov.tr](http://www.kosgeb.gov.tr)

2011 Yılında  
KOSGEB Destekli  
Bakım